



## Section 1.4

---

### ICON HEALTHCARE ALERT SIGNAGE

#### Corridor Alert Signs

#### Patient Room Alert Signs

### PRICE LIST & SPECIFICATIONS

Effective September 1, 2022

All Prices are Suggested List Price

PLEASE NOTE:

Our quick ship service, **PDQ**, is currently unavailable. All orders are subject to current lead times. For inquiries regarding current lead times, please contact Peter Pepper Products Customer Service.

1.4



# ICON Healthcare Alert Signage

## Corridor Alert Signs



C8 shown with Rectilinear Header and EMB



C10



C12

1.4

The ICON Corridor Alert sign communicates critical patient information to the doctor, nurse or clinician. Easily lock and unlock the colorful information tabs as needed, using the “push and slide” system concealed behind the hinged panel. Icon tabs are 1 7/8”w x 1 7/8”h. Combine additional Infectious Disease Control inserts and room identification in a single system. ICON is ADA compliant and may be customized to meet the requirements of your facility, department or unit. Please submit your requirements.

| Model              | Description                | Size             | No Header* | With Header | Dry Erase Film Upcharge | Est. Ship Wt. |
|--------------------|----------------------------|------------------|------------|-------------|-------------------------|---------------|
| <b>8 1/2" wide</b> |                            |                  |            |             |                         |               |
| C8                 | 8 Icon Tabs, bottom hinge  | 8 1/2w x 12h     | \$ 490     | \$ 562      | \$ 81                   | 3             |
| C10                | 10 Icon Tabs, bottom hinge | 8 1/2w x 15h     | 579        | 650         | 100                     | 4             |
| C12                | 12 Icon Tabs, bottom hinge | 8 1/2w x 16 1/4h | 626        | 698         | 107                     | 5             |

For Icon Tabs, see page 70.

\*Height dimensions include headers. Deduct 2 1/2" for no header models.

### Header Styles - C8, C10 & C12 models only (shown with optional EMB)

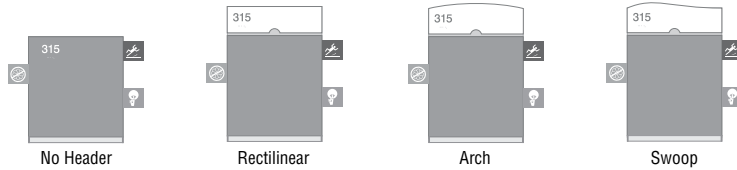

C4S shown with EMB

| Model                         | Description                          | Size            | No Header | Dry Erase Film Upcharge | Est. Ship Wt. |
|-------------------------------|--------------------------------------|-----------------|-----------|-------------------------|---------------|
| <b>Single-Sided, 6 1/2" w</b> |                                      |                 |           |                         |               |
| C4S                           | 4 Icon Tabs, single-sided, top hinge | 6 1/2w x 9 3/4h | \$ 375    | \$ 63                   | 2             |

For Icon Tabs, see page 70.

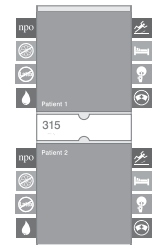

DP16 shown with EMB

| Model                      | Description   | Size         | With Header | Dry Erase Film Upcharge | Est. Ship Wt. |
|----------------------------|---|--------------|-------------|-------------------------|---------------|
| <b>Dual Occupancy Sign</b> |   |              |             |                         |               |
| DP16                       | With 8 Icon Tabs per patient<br>Individual Patient 1 and Patient 2 identification<br>Top panel hinged on the top; bottom panel hinged on the bottom | 8 1/2w x 22h | \$ 1,111    | \$ 170                  | 6             |

For Icon Tabs, see page 70.

FOB Pennsylvania

### Specifications & Ordering Information (See pages 71 - 72)



# ICON Healthcare Alert Signage

## Corridor Alert Signs

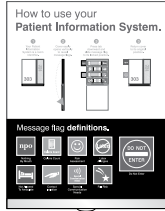

**PSTR**

Staff Education Poster



**C8 with CPH**

Horizontal placard slides into the front hinged panel frame



**C12 with CPD**

Vertical placard slides into the front hinged panel frame



**C8 with CPU**

Placard holder mounts under the hinged panel and the vertical placard slides into place

| Model   | Description   | Size       | List   | Est. Ship Wt. |
|---|---|------------|--------|---------------|
| <b>Options</b>  |   |            |        |               |
| <b>EMB</b>  | Embossed Room Number, Helvetica ¾h, and Braille on header or hinged panel. ADAAG compliant                                    |            | \$ 140 |               |
| <b>ICON</b>   | Replacement Icon Tabs   |            | 66     |               |
| <b>PSTR</b>   | Staff Education Poster, customized with your specific icons. Clear acrylic holder   | 22w x 28h  | 339    | 8             |
|   | Text, instead of Icon image, one-time set up, each  |            | 119    |               |
|   | Custom Icon design, one-time set up, each   |            | 564    |               |
|   | Logos and custom images   |            | 76     |               |
|   | Any PMS Icon or hinged panel color  |            | n/c    |               |
| <b>Infectious Disease Control Placard Inserts</b>   |   |            |        |               |
| The Infectious Disease Control Placard Inserts along with "Do Not Enter" help to ensure better outcomes for your National Patient Safety goal program for reducing the incidence of healthcare-associated infections (HAI's). These inserts are digitally printed on durable, tear and moisture resistant material. Placards insert into a non-glare acrylic holder. Additional inserts can be customized to your needs. Please submit your requirements. |   |            |        |               |
| <b>CPH</b>  | Horizontal Placard Insert for hinged panel (Models C8, C10, C12 & DP16)<br>Set of 4, double-sided, with acrylic holder        | 8¾w x 3¾h  | 190    | 1             |
| <b>CPH-A</b>  | Acrylic holder only, no placards  | 8¾w x 3¾h  | 73     |               |
| <b>CPD</b>  | Vertical Placard Insert for hinged panel (Models C10 & C12)<br>Set of 4, double-sided, with acrylic holder                    | 8¾w x 10¾h | 347    | 1             |
| <b>CPD-A</b>  | Acrylic holder only, no placards  | 8¾w x 10¾h | 140    |               |
| <b>CPU</b>  | Vertical Placard Insert mounts under hinged panel (Models C8, C10, C12 & DP16)<br>Set of 4, double-sided, with acrylic holder | 8¾w x 10¾h | 347    | 1             |
| <b>CPU-A</b>  | Acrylic holder only, no placards  | 8¾w x 10¾h | 140    |               |

**1.4**

FOB Pennsylvania

### CPH — Set of 4 double-sided placards

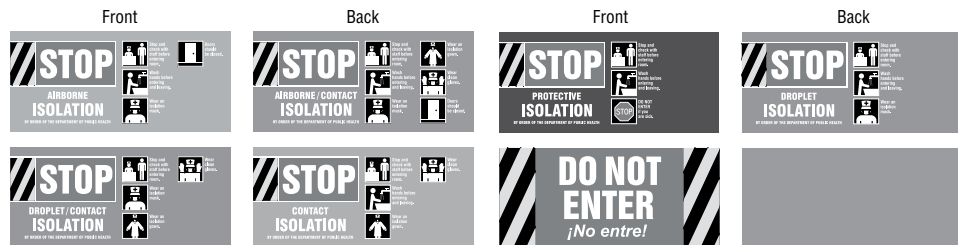

### CPD & CPU

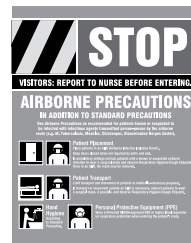

**Specifications & Ordering Information** (See pages 71 - 72)



# ICON Healthcare Alert Signage

## Information Icon Library

The standardized Information Icon library is easily augmented with any custom symbols and icons your care providers desire. Here is a sample of symbols currently found in the ICON library. We can design custom symbols to meet your facility's needs and brand. All icons can be designed to be multi-lingual.

### Icon Colors - Specify icon number and color.\*

PMS referenced colors approximate actual colors.

Contact factory for samples.

|        |           |            |           |
|--------|-----------|------------|-----------|
| Red    | PMS 200M  | Ocean Mist | PMS 5425M |
| Orange | PMS 021M  | Naval Blue | PMS 286M  |
| Yellow | PMS 1235M | Purple     | PMS 2607M |
| Green  | PMS 349M  |            |           |

\*Text, custom colors and Icons available. Please submit your requirements.

1.4



### Icon Index

1. Fall Risk
2. Nothing By Mouth
3. Immuno Compromise
4. Droplet Isolation
5. Not Allowed to Ambulate
6. Contact Isolation
7. Deceased
8. Pain Assessment
9. Patient at Test
10. Dizziness
11. Elopement
12. Latex Allergies
13. Physician Consult
14. Patient Code
15. Patient Code
16. Patient Code
17. Patient Code
18. Special Precautions
19. See Nurse
20. See Nurse Before Entering
21. Special Communications Needs
22. Seizure Precautions
23. Mother with Child
24. Calorie Count
25. I & O
26. Strict I & O
27. Hearing Impaired
28. Sight Impaired
29. No Venipuncture in Right Arm
30. No Venipuncture in Left Arm
31. Daily Weights
32. Fluid Restrictions
33. Swallowing Precautions
34. Quiet Please!
35. Caution Oxygen
36. Special Output Sampling
37. Neutropenic Precautions
38. Transplant Precautions
39. Transfusion Protocol
40. Allergy Precautions
41. Please Keep Door Closed
42. Wash Hands Before Entering
43. 24 Hour Specimen
44. Children Present
45. Plant Allergy Precaution
46. Food Allergy Precaution
47. Patient With Family
48. Patient With Pastor
49. Patient Eating
50. Aphasic
51. Aspiration Precautions
52. Bereavement
53. Pre-Term Infant
54. Do Not Resuscitate
55. Chair Alarm
56. Physician
57. Bloodwork
58. Consent
59. Injection
60. MRSA Infection
61. Labs Pending
62. Patient Demise
63. Biohazard
64. Chemotherapy
65. Aggression
66. Nurse to Remove Tray
67. Epidural
68. No Bottle
69. Shh, Quiet
70. Asphasia

All models include an Icon Index decal, mounted to the inside of the hinged panel for easy reference.



# ICON Healthcare Alert Signage

## Ordering Information and Specifications

### HOW TO SPECIFY ICON TABS



Left: top to bottom & Right: top to bottom  
Icon number (see page 70) and color

|            |               |
|------------|---------------|
| #2 purple  | #1 naval blue |
| #3 red     | #5 ocean mist |
| #12 orange | #34 yellow    |
| #4 green   | #20 red       |

### Header Styles - C8, C10 and C12 Models only

Shown with optional EMB - Embossed Room Number and Braille

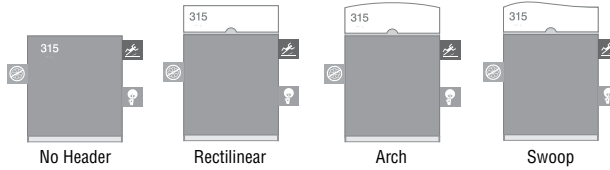

No Header

Rectilinear

Arch

Swoop

### Tab Configurations - C8, C10, C12 & DP Models

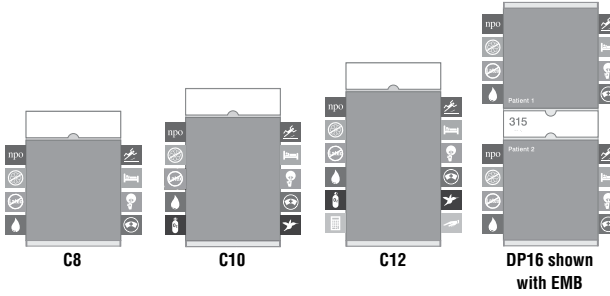

C8

C10

C12

DP16 shown  
with EMB

### Tab Configurations - Model C4S



C4S shown  
with EMB

# ICON Healthcare Alert Signage

## Ordering Information and Specifications

1.4

### To Order Specify

1. Quantity
2. Model
3. Panel Color
4. Header Style (C8, C10 & C12 Models only)
5. Header Color
6. Icon Tab Number, Tab Color and Order (left top to bottom and right top to bottom)
7. Options

#### Header Styles (C8, C10 & C12 Models only)

No Header  
Rectilinear  
Arch  
Swoop

#### Header & Panel Finishes

Soft White  
Haze  
Seasand  
Wheat  
Khaki  
Lemongrass  
Ocean Mist  
Aluminum Metallic  
Taupe Metallic

#### Icon Tab Colors

Red  
Orange  
Yellow  
Green  
Ocean Mist  
Naval Blue  
Purple  
Custom Colors  
(Submit your requirements)

**Icon Tab Numbers: See page 70**

See PPP Color Card or Web

### Specifications

The ICON Healthcare Alert signs communicate critical patient information to the next doctor, nurse or clinician. Easily lock and unlock the colorful information tabs as needed, using the “push and slide” system concealed behind the hinged panel. Combine room identification and additional Infectious Disease Control inserts in a single system.

ICON is ADA (Accessibility Guidelines) compliant and may be customized to meet the requirements of your facility, department or unit.

- Construction: 24 ga. galvaneal steel hinged panel with magnetic latch. ½” depth. Hinged panel is magnetic and finished in acrylic polyurethane. Backer .063 aluminum.
- Header (C8, C10, C12 & DP Models only): Acrylic 2½”h x ¾”d. Dimensions on C8, C10 & C12 models include headers - subtract 2½” for models without headers.
- **Optional Embossed Room Number/Letter**, Helvetica type ¾”h, and Braille. Submit list of room numbers and specify placement on header and/or hinged panel when applicable.
- Icon Tabs: White icon on color tab, *specify color*. Digitally printed on durable .125” expanded PVC. Icon tabs are easily removed or changed.  
C & DP Models: 1⅞”w x 1⅞”h.
- Placard Inserts: With non-glare acrylic lens.
- Optional dry erase writing surface film for hinged panel — Upcharge.
- Mounting: Double-sided tape, standard; concealed pre-drilled holes for screw fasteners on request.
- Included: All models include an Icon Index decal, mounted to the inside of the hinged panel for easy reference.

© 5/2022

